

## Triplex Plunger Pump K 35000 – 3G

P 45-1

15.10.2016

The K 35000 high-pressure pump with input of 350kW serves a variety industries and processes globally. Some common applications include chemical, petrochemical, hydraulics, mobile jetting, seawater service and mining. The K 35000 with a forced-lubricated gear and oil cooler meets demanding round the clock operating conditions onshore or off. Constructed in the classic KAMAT modular component system, this model offers flexible adaptation to changing process parameters such as operating pressure and fluid medium.



- Flow rate based upon 100% volumetric efficiency and 20°C ambient temperature
- Minimum inlet pressure depends on fluid medium
- Speed range 10-100% depending on rod force
- Gear dynamically balanced
- Gear with force-fed and oil cooler
- Standard gear ratios  $i = 3,39 - 4,05 - 4,76 - 5,25$
- API 674 and ATEX versions available



$n_{nom} = 440 \text{ 1/min}$		p max. bar @ kW				Head type		
Type	l/min	280 kW	315 kW	330 kW	350 kW	A	M	MC
K 35018 – 3G	47	3100	3500	-----	-----	1		
K 35020 – 3G	58	2500	2800	2950	3150	1		
K 35022 – 3G	70	2075	2335	2440	2500	1		
K 35024 – 3G	83	1750	1950	2050	2200	1		
K 35026 – 3G	98	1480	1670	1750	1880	1		
K 35028 – 3G	114	1280	1440	1540	1620	1		
K 35030 – 3G	131	1150	1300	1350	1440	1		
K 35032 – 3G	149	1020	1150	1200	1265	1		
K 35036 – 3G	188	815	905	950	1000	1		H
K 35040 – 3G	232	665	755	780	810	1		H
K 35045 – 3G	294	525	595	625	640	1		H
K 35050 – 3G	363	405	455	480	505	1	1	H
K 35055 – 3G	439	335	375	395	420		1	1
K 35060 – 3G	523	280	315	330	350		1	1
K 35065 – 3G	613	240	270	285	300		1	1
K 35070 – 3G	711	205	230	245	260		1	1
K 35075 – 3G	816	180	200	210	225			1
K 35080 – 3G	928	160	180	185	195			1
K 35085 – 3G	1049	140	160	165	175			1
K 35090 – 3G	1175	125	140	150	155			1
K 35095 – 3G	1310	110	125	130	140			1

API 674 = max. 290 1/min

= Ultra High Pressure UHP

KAMAT GmbH & Co. KG

Salinger Feld 10, 58454 Witten, Deutschland, Fon +49 (0)23 02 / 89 03-0, Fax +49 (0)23 02 / 80 19 17, info@KAMAT.de, www.KAMAT.de

Technische Änderungen vorbehalten. / The right to technical changes is reserved.

## Dimensional Drawing K 35000 – 3G

~ 1360 kg

P 45-2

01.06.2018

Typ A  
Type A

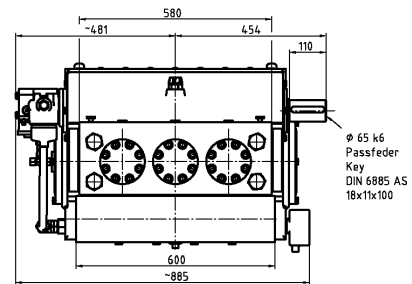
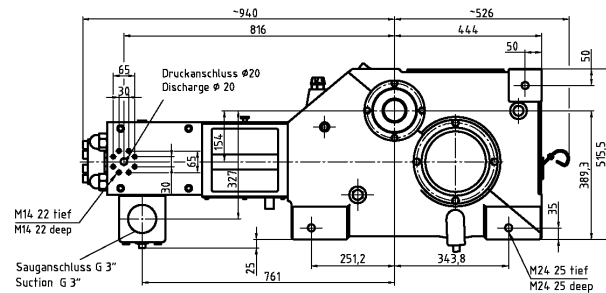

Typ M  
Type M

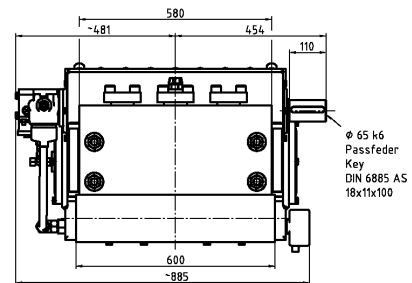
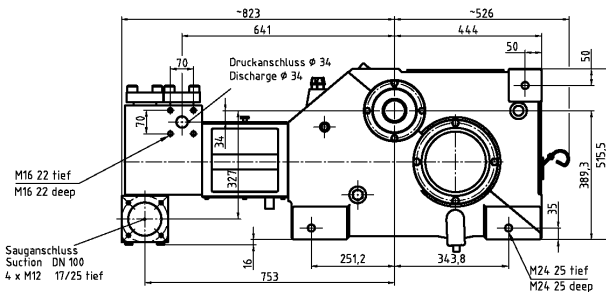

Typ MC  
Type MC

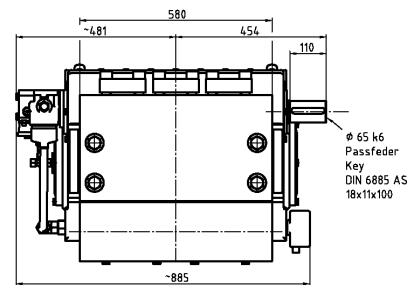
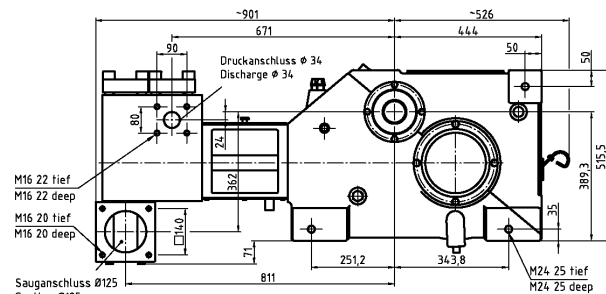

Typ MCH  
Type MCH

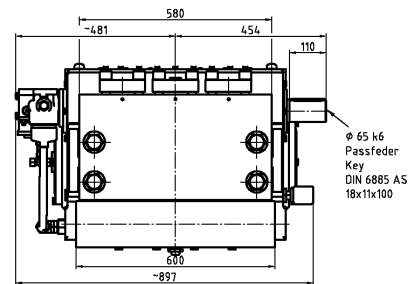
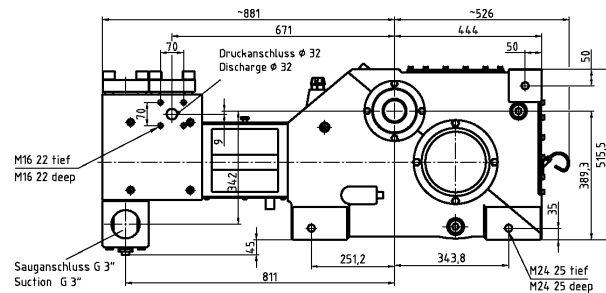

Typ A  
Type A  
 $\geq 1500$  bar

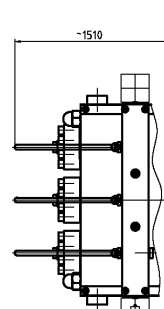

Fußmaßzeichnung  
Footprint

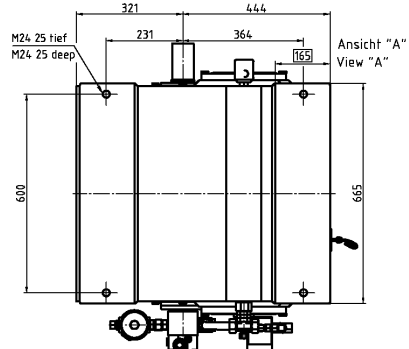

Höchstdruckkopf  $\geq 1500$  bar  
High Pressure Head  $\geq 1500$  bar